

Basic Hygiene

Standard precautions
Environmental cleaning

Day 2



Standard precautions

Aim:

- Reduce infection transmission from known and unknown sources
- Protect healthcare workers, patients and general public
- Should be applied
 - By all healthcare workers
 - For all patients
 - At any time

Standard precautions

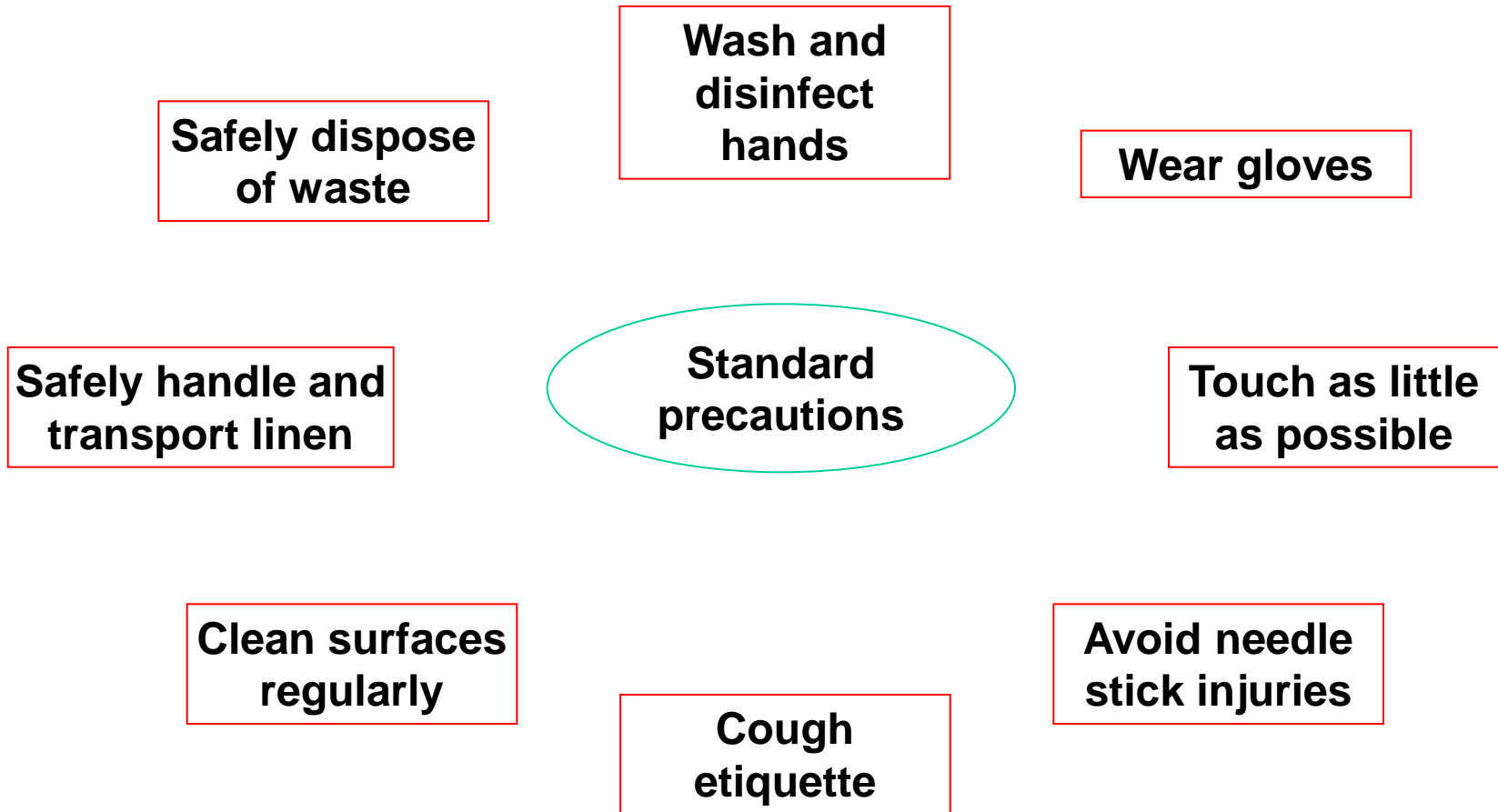

Your 5 moments for HAND HYGIENE

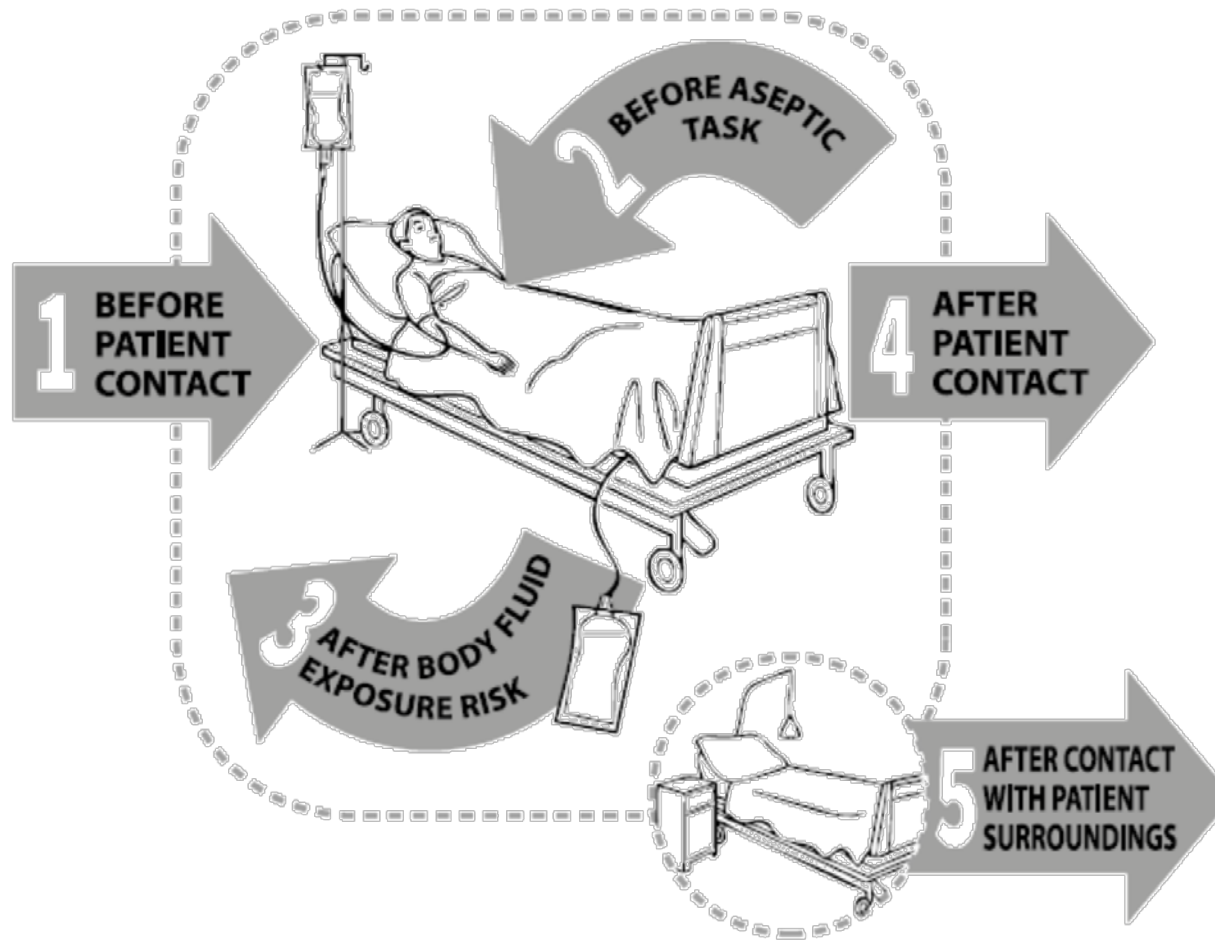

How to Handwash?

WASH HANDS WHEN VISIBLY SOILED! OTHERWISE, USE HANDRUB

 Duration of the entire procedure: 40-60 seconds



Wet hands with water;



Apply enough soap to cover all hand surfaces;



Rub hands palm to palm;



Right palm over left dorsum with interlaced fingers and vice versa;



Palm to palm with fingers interlaced;



Backs of fingers to opposing palms with fingers interlocked;



Rotational rubbing of left thumb clasped in right palm and vice versa;

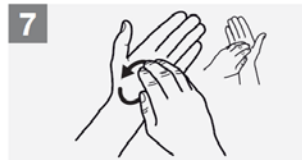

Rotational rubbing, backwards and forwards with clasped fingers of right hand in left palm and vice versa;



Rinse hands with water;



Dry hands thoroughly with a single use towel;

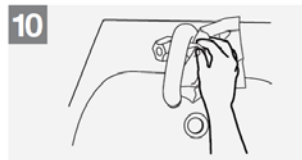

Use towel to turn off faucet;



Your hands are now safe.



World Health Organization

Patient Safety

A World Alliance for Safer Health Care

SAVE LIVES

Clean Your Hands

All reasonable precautions have been taken by the World Health Organization to verify the information contained in this document. However, the published material is being distributed without warranty of any kind, either expressed or implied. The responsibility for the interpretation and use of the material lies with the reader. In no event shall the World Health Organization be liable for damages arising from its use. WHO acknowledges the Hôpitaux Universitaires de Genève (HUG), in particular the members of the Infection Control Programme, for their active participation in developing this material.

May 2009

Environmental cleaning

- Disinfect floors, walls, surfaces
- Disinfect patient's objects, clothes, linens, beds, eating utensils
- Disinfect reusable equipment (boots, aprons, goggles)
- Disinfect body fluid spills, vomit, faeces

Commonly used chlorine solutions

Concentration		Cholera-setting	VHF-setting
0.5 g/L	0.05%	Washing ungloved hands, Disinfect eating utensils	Washing ungloved hands, Disinfect eating utensils, clothes
2 g/L	0.2%	Disinfect floors, walls, feet, clothes, beds	
5 g/L	0.5%		Washing gloved hands, Disinfect surfaces, objects, body fluid spills, boots, corpses
20 g/L	2.0%	Disinfect vomit, faeces, corpses	
0.3-0.5 mg/L		Drinking water	

How to prepare chlorine solution from common household bleach

3.5% or 35g/L or 12°

→ 0.5% Chlorine solution

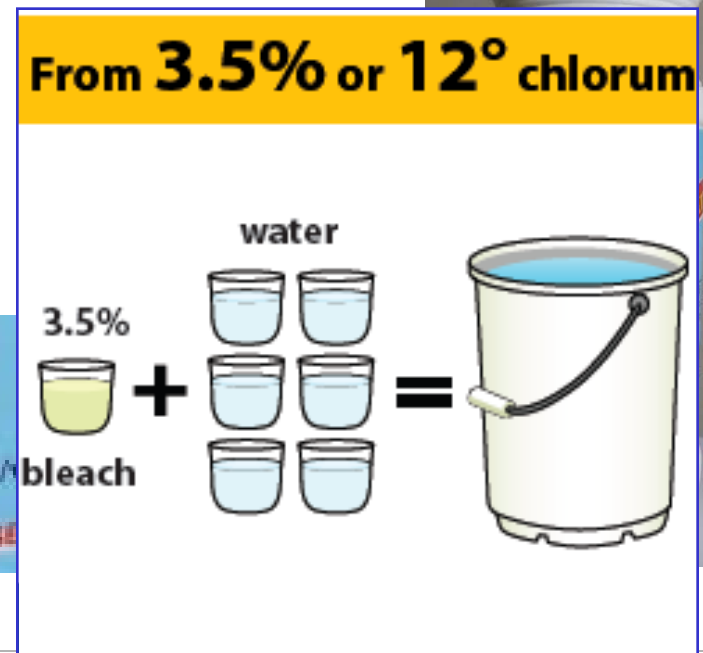
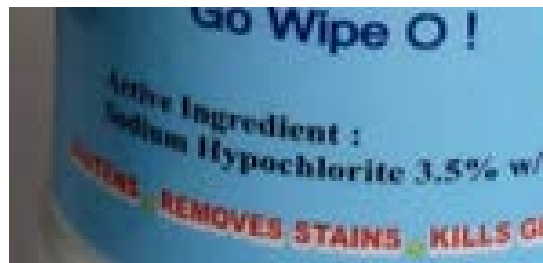

How to prepare chlorine solution from common household bleach (3.5%)

Target solution	Formula	Bleach	Water
0.05%	$\frac{3.5\%}{0.05\%} - 1 = 70 - 1 = 69$	1	69
0.2%	$\frac{3.5\%}{0.2\%} - 1 = 17.5 - 1 = 16.5$	2	33
0.5%	$\frac{3.5\%}{0.5\%} - 1 = 7 - 1 = 6$	1	6
2.0%	$\frac{3.5\%}{2.0\%} - 1 = 1.75 - 1 = 0.75$	4	3

How to Make Strong (0.5%) Chlorine Solution from Liquid Bleach

Use strong (0.5%) chlorine solution to clean and disinfect surfaces, objects, and body fluid spills.

Make new strong (0.5%) chlorine solution every day. Throw away any leftover solution from the day before.



1

Make sure you are wearing **extended PPE**.

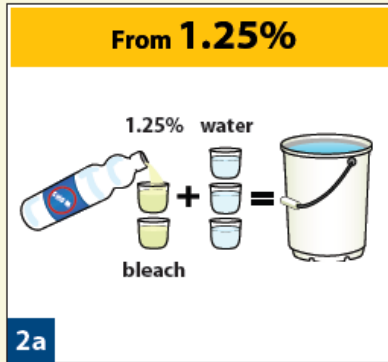

2a

Pour 2 parts liquid bleach and 3 parts water into a bucket. Repeat until full.

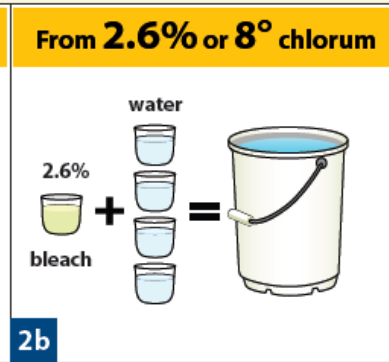

2b

Pour 1 part liquid bleach and 4 parts water into a bucket. Repeat until full.

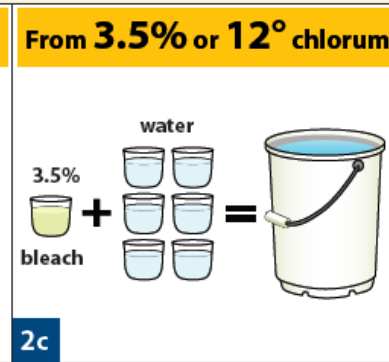

2c

Pour 1 part liquid bleach and 6 parts water into a bucket. Repeat until full.

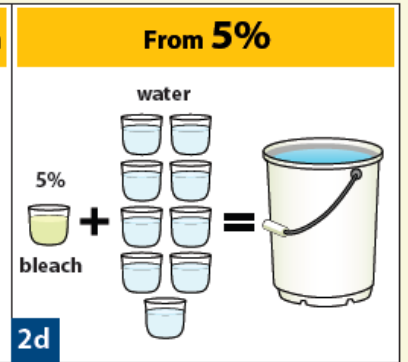

2d

Pour 1 part liquid bleach and 9 parts water into a bucket. Repeat until full.

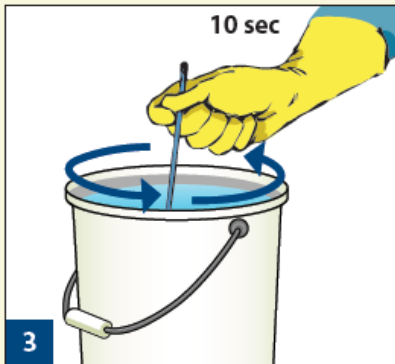

3

Stir well for 10 seconds.

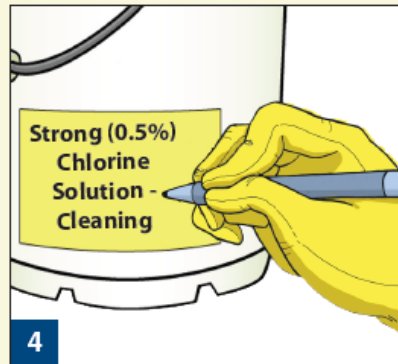

4

Label bucket "**Strong (0.5%) Chlorine Solution - Cleaning.**"

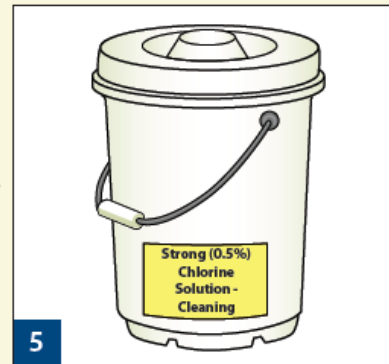

5

Cover bucket with lid.



6

Store in shade. Do not store in direct sunlight.



Group work 1 – Prepare chlorine solution from common household bleach (3.5%)

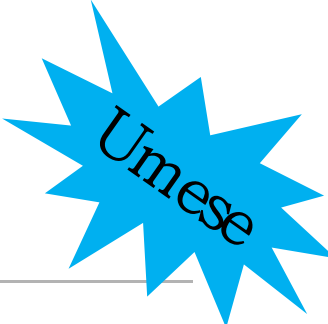

Decontamination



0.5%

0.05%

2.0%

Handwashing





Group work 2 – Hand hygiene

- When to wash hands
- How to wash hands
- How to handrub
- Touch as little as possible

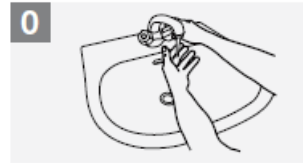

0 Wet hands with water;



1 Apply enough soap to cover all hand surfaces;



2 Rub hands palm to palm;



3 Right palm over left dorsum with interlaced fingers and vice versa;



4 Palm to palm with fingers interlaced;



5 Backs of fingers to opposing palms with fingers interlocked;



6 Rotational rubbing of left thumb clasped in right palm and vice versa;



7 Rotational rubbing, backwards and forwards with clasped fingers of right hand in left palm and vice versa;



8 Rinse hands with water;



9 Dry hands thoroughly with a single use towel;

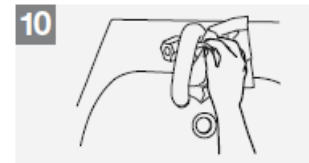

10 Use towel to turn off faucet;



11 Your hands are now safe.

Group work 3 – Wear gloves...

... and safely remove them



Group work 4 - Drawing a sketch of a cholera treatment centre

Ushafa

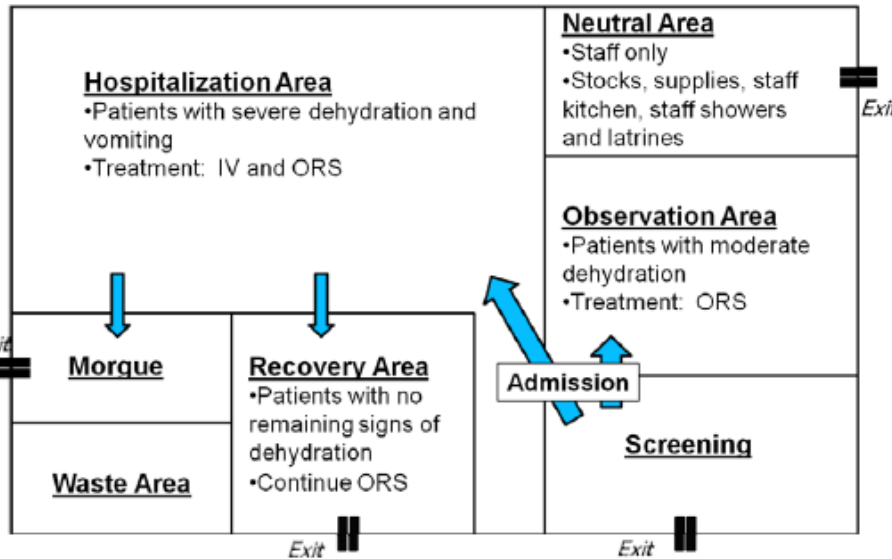

- 1 = Chlorine
- 2 = Handwash
- 3 = Gloves
- 4 = Sketch

Rotation plan for group work

Group	Practical			
Apple	Groupwork 1	Groupwork 2	Groupwork 3	Groupwork 4
Banana	Groupwork 2	Groupwork 3	Groupwork 4	Groupwork 1
Coconut	Groupwork 3	Groupwork 4	Groupwork 1	Groupwork 2
Dodo	Groupwork 4	Groupwork 1	Groupwork 2	Groupwork 3